

Level	Date	By
(A)		
(B)		
(C)		
(D)		

ROCHESTER DIVISION PRODUCT PRINT

The information disclosed in this drawing is confidential and the property of Schlegel Electronic Materials, INC. The use, disclosure, or reproduction of this information and related know-how is prohibited without written permission from Schlegel Electronic Materials, INC.

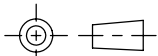
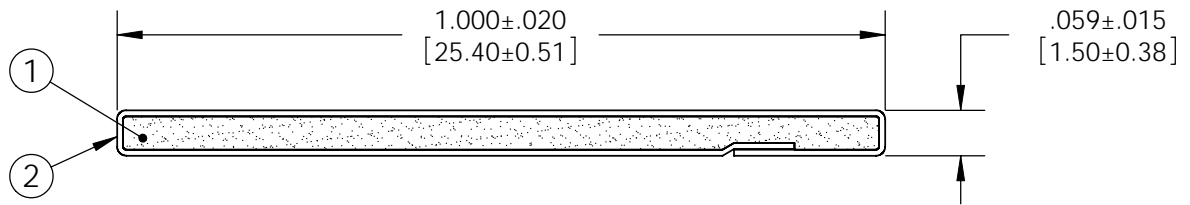
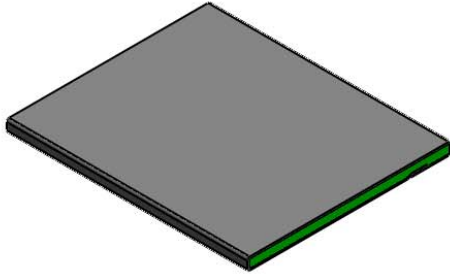

TOLERANCES

Profile thickness: ± 0.015 " (0.38mm)
 Profile width: ± 0.020 " (0.51mm)



SCALE 1:1

PDR NO.:	(4)		
QUOTE NO.:	(3)		
CUSTOMER NAME:	(2)	SEE B.O.M.	CONDUCTIVE FABRIC
CUST DWG NO.:	(1)	SEE B.O.M.	URETHANE FOAM
SIZE A	Date 9/3/2009	Item No.	Material Description
SCALE: 4:1		Approved By	Drawn By BEP
SHEET 1 OF 2		Title 1.5mm x 25.4mm EMI	
Cad File No. DC48411	Part No. EW4xxXXXXX	Dwg. No. DC3E4841	Rev.

Level	Date	By
(A)		
(B)		
(C)		
(D)		

ROCHESTER DIVISION PRODUCT PRINT

The information disclosed in this drawing is confidential and the property of Schlegel Electronic Materials, INC. The use, disclosure, or reproduction of this information and related know-how is prohibited without written permission from Schlegel Electronic Materials, INC.

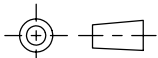
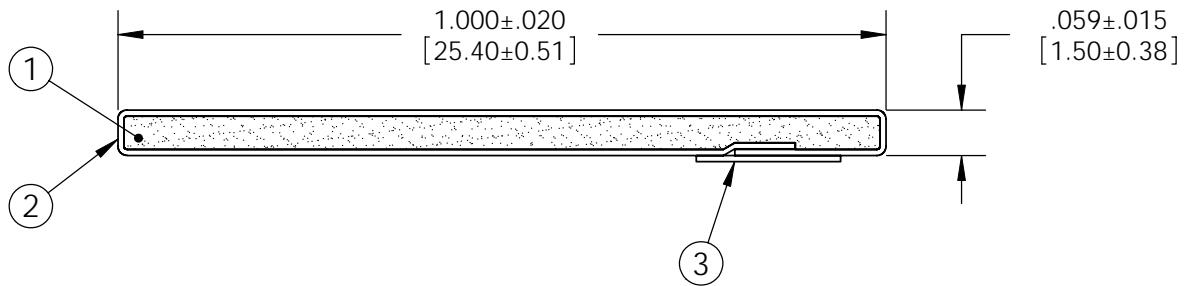
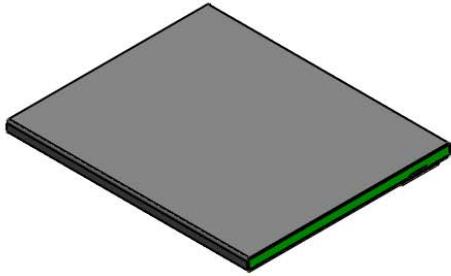

TOLERANCES

Profile thickness: $\pm .015"$ (0.38mm)
 Profile width: $\pm .020"$ (0.51mm)



SCALE 1:1

PDR NO.:	(4)		
QUOTE NO.:	(3)	SEE B.O.M.	PSA .188" WIDE (UNLESS OTHERWISE SPECIFIED)
CUSTOMER NAME:	(2)	SEE B.O.M.	CONDUCTIVE FABRIC
CUST DWG NO.:	(1)	SEE B.O.M.	URETHANE FOAM
SIZE A	Date	9/3/2009	
SHEET 2 OF 2		Item No.	Material Description
SCALE: 4:1	Approved By	Drawn By	BEP
Title		1.5mm x 25.4mm EMI	
Cad File No.	DC48411	Part No.	EW4xxTxxxxx
Dwg. No.	DC3E4841	Rev.	